

## MASTER PIN

Used with special washer, castle nut and split pin.

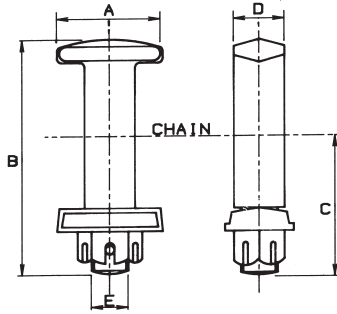

	Dimensions in mm		
	348	458	678
A	24	32	46
B	57	72.3	98.8
C	35	44.5	60.3
D	12.7	15.8	22.2
E	M10	M12	M16

## EXTENDED PIN

Length of extension (C) and thread length (H) to be specified by the customer.

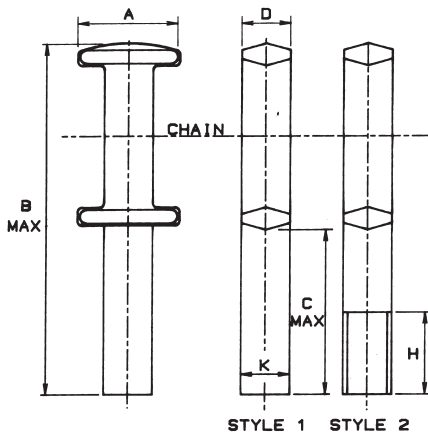

	Dimensions in mm		
	348	458	678
A	24	32	46
B max	74	112	157
C max	30	55	30
D	12.7	15.8	22.2
K	12.7	15.8	22.2

## EXTENDED SHOULDER PIN

Length of extension (C), shoulder length (G), thread size (F) and thread length (H) to be specified by the customer.

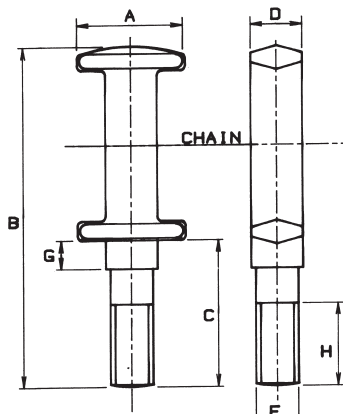

	Dimensions in mm		
	348	458	678
A	24	32	46
B max	57	112	157
C max	35	55	80
D	12.7	15.8	22.2